

## RB DISTRICT LAND USE

Property Owner	Address	Total Lot Size in acres	Farmland	Forested	Other	Map & Lot
Keenan	3 Spoodrift Lane	4.5	0	4.5	0	U12-11
Armstrong	18 Avon Road	10.74	0	10	0.74	R3-16
Turkey Hill Farm LLC.	24 Woodland Road	25	4.5	17	3.5	R3-20
Town of Cape Elizabeth	320 Ocean House Road	18	0	18	0	R1-2-A
Bottomley	28 Deer Field Road	24	0	8	16	U32-13
Garland	23 Deer Field Road	12	0	4.5	7.5	U32-13-1
Bothel	90 Ocean House Road	8.57				U26-6-5
Bothel	90 Ocean House Road	0.89				U26-6-A
Purpoodock	300 Spurwink Avenue	31.7	0	31.7	0	R4-4
Davis	313 Spurwink Avenue	30	2	26	2	R4-7-A
Dell Aquilla	362 Spurwink Avenue	3.5	0	2	1.5	R5-22-2
Potter	356 Spurwink Avenue	2.75	0	0.5	2.25	R5-22
Jordan	21 Wells Road	67.87	25	39	3.87	R5-30
Gabriel	81 Wells Road	11	0	7	4	R5-40-1
Spurwink Rod & Gun	33 Littlejohn Road	21	0	20.5	0.5	R5-50
Boy Scouts/Henry Adams	3 Todd Road	16	0	16	0	R5-52-A
Sahrbeck	15 Silva Drive	26	0	25	1	U46-9
Eastman Meadows	Tanager Lane		approved 46 units			R4-18-999
Maskewitz-McMullin	221 Fickett Street	1.86	0	0	1.86	R4-51-5
Young IV	1127 Sawyer Road	2.28	0	0	2.28	R4-51-7
Peruzzi	1131 Sawyer Road	1.87	0	0	1.87	R4-51-6
Young	1119 Sawyer Road	112	15	96	1	R4-51
Schroder	Switzerland	11	0	10	1	R2-21
Dell Aquila, A	368 Spurwink Avenue	33	0	13	20	R5-19-L
Dell Aquila, M	362 Spurwink Avenue	13.75	0	6	7.75	R5-22-A
Sprague Corp.	1 Ram Island Farm	5	0	5	0	R5-26

# RB District Aerial photos and Estimated Land Use Areas



1,000:600 0 1,000 Feet

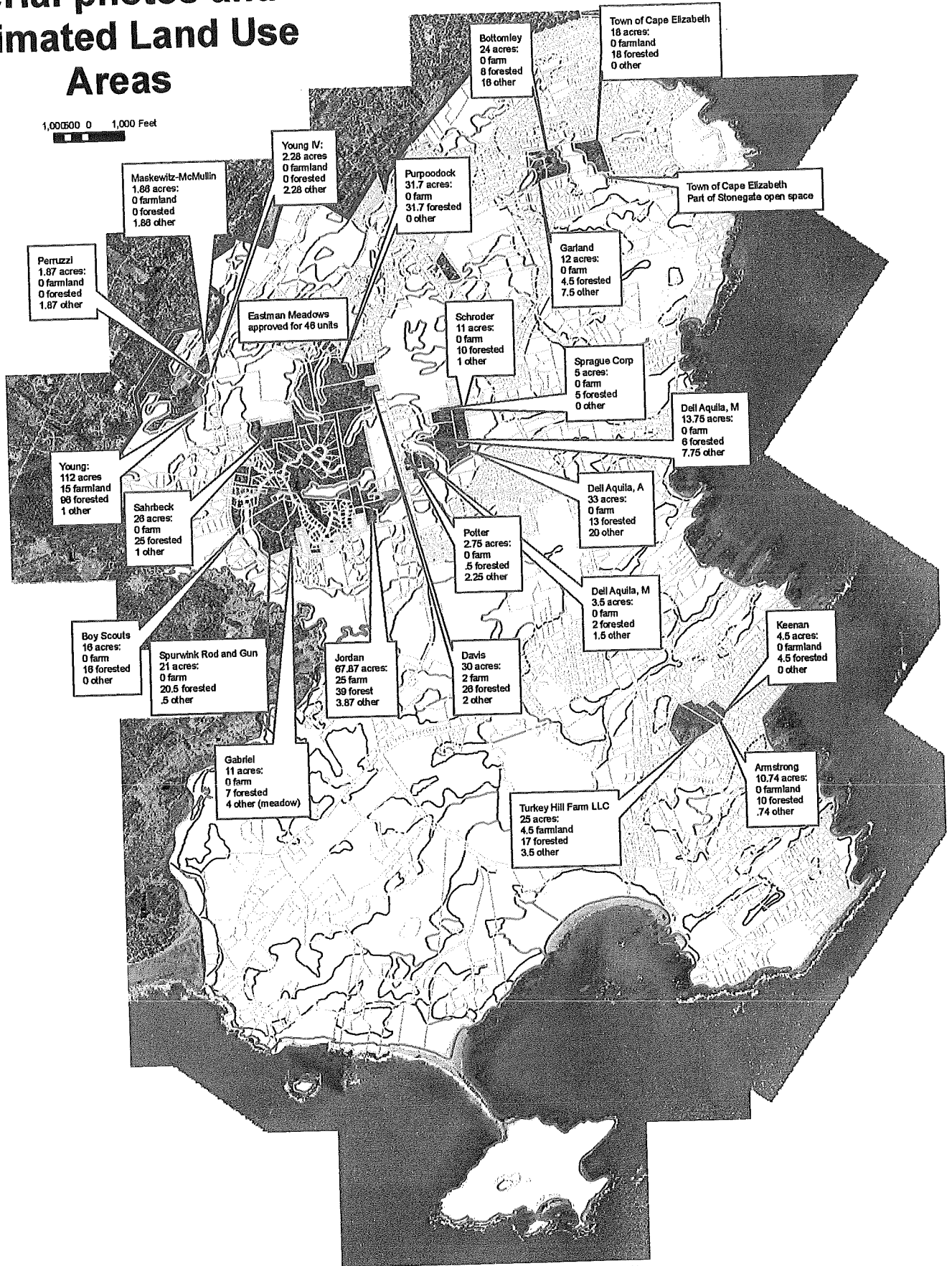

7.23  
RESTRICTED BUFFERS - "CLASSIFIED  
BUFFERS, NO DISTURBANCE" - SEE  
PROJECT NOTES #4.

7.23  
RESTRICTED BUFFERS - "CLASSIFIED  
BUFFERS, NO DISTURBANCE" - SEE  
PROJECT NOTES #4.

7.23  
RESTRICTED BUFFERS - "CLASSIFIED  
BUFFERS, NO DISTURBANCE" - SEE  
PROJECT NOTES #4.

7.23  
RESTRICTED BUFFERS - "CLASSIFIED  
BUFFERS, NO DISTURBANCE" - SEE  
PROJECT NOTES #4.

7.23  
RESTRICTED BUFFERS - "CLASSIFIED  
BUFFERS, NO DISTURBANCE" - SEE  
PROJECT NOTES #4.

7.23  
RESTRICTED BUFFERS - "CLASSIFIED  
BUFFERS, NO DISTURBANCE" - SEE  
PROJECT NOTES #4.

7.23  
RESTRICTED BUFFERS - "CLASSIFIED  
BUFFERS, NO DISTURBANCE" - SEE  
PROJECT NOTES #4.

7.23  
RESTRICTED BUFFERS - "CLASSIFIED  
BUFFERS, NO DISTURBANCE" - SEE  
PROJECT NOTES #4.

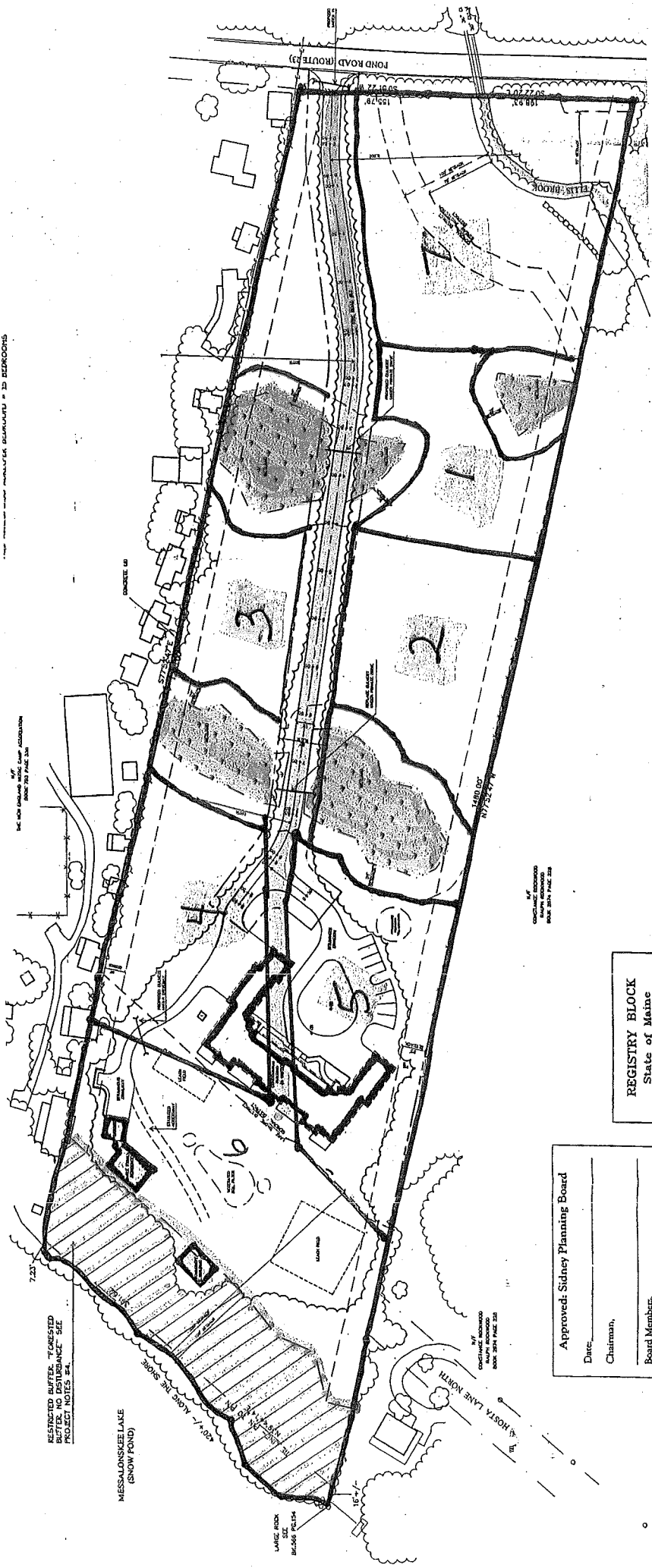

Approved: Sidney Planning Board  
Date: \_\_\_\_\_  
Chairman, \_\_\_\_\_  
Board Members, \_\_\_\_\_

REGISTRY BLOCK  
State of Maine

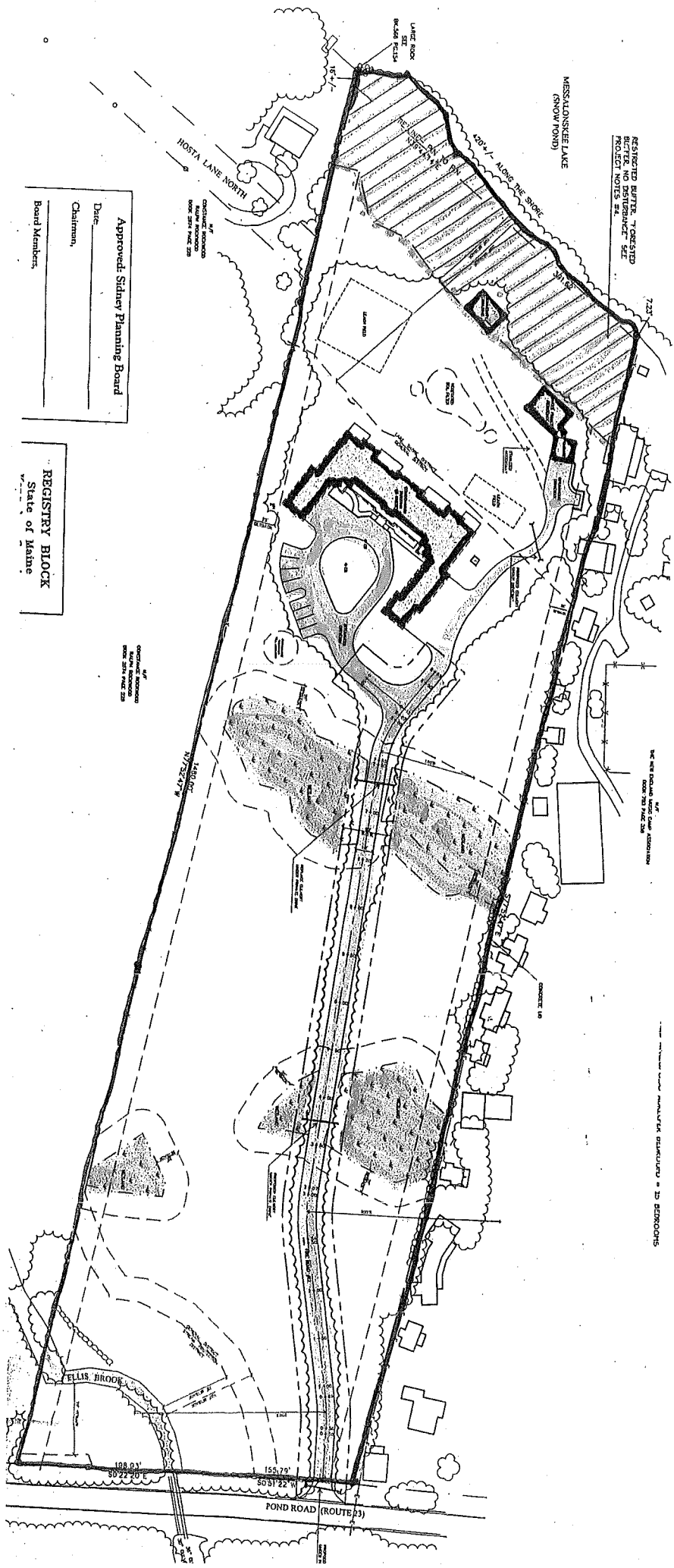

RESTRICTED BUFFER "DESIGNED PROJECT NOTES"

MESSALONSKEE LAKE (SNOWDON)

HORTA LANE NORTH

POND ROAD (ROUTE 33)

Approved: Sidney Planning Board  
 Date: \_\_\_\_\_  
 Chairman, \_\_\_\_\_  
 Board Members, \_\_\_\_\_

REGISTRY BLOCK  
 State of Maine

1/2" = 100' (SEE PLAN FOR DIMENSIONS)

1/8" = 100' (SEE PLAN FOR DIMENSIONS)

1/2" = 100' (SEE PLAN FOR DIMENSIONS)

1/2" = 100' (SEE PLAN FOR DIMENSIONS)

188.0' S022°20' E

155.70' S031°22' W